

# kranzle



High Pressure Cleaners

Pressure Washer Accessories

Wet and Dry Vacuum Cleaners

General Cleaning Equipment





## Domestic Cold Water



1050 P

1050 TS

1050 TST

7.5L at 130 Bar - 2800 r.p.m

## Light Commercial Cold Water



X-Line A15 - 8L at 130 Bar  
230V - 1400 r.p.m

X-Line A17 - 9L at 150 Bar  
230V - 2800 r.p.m

## Compact and Commercial-duty Cold Water



2175 TS - 12L at 160 Bar  
400V - 1400 r.p.m

2160 TS - 11L at 140 Bar  
230V - 1400 r.p.m

7/122 TS - 7L at 120 Bar  
230V - 1400 r.p.m

HD 11/130 TS  
11L at 130 Bar - 230V - 1400 r.p.m

Contractor 11/130 TS

## Industrial Cold Water High Pressure Cleaners



Quadro 599 - 230V - 10L at 150 Bar  
Quadro 799 - 400V - 13L at 180 Bar  
Quadro 899 - 400V - 15L at 150 Bar

Bully 1000 - 400V  
16L at 220 Bar

Quadro  
800/ 1000/ 1200/ 1500 TS  
400V - 1400 r.p.m.

Kränzle Hire Version  
599 - 10L at 150 Bar  
799 - 13L at 180 Bar

WS Stationary Models  
13L at 250 Bar / 16L at 220 Bar  
19L at 180 Bar / 25L at 140 Bar  
400V - 1400 r.p.m.

## Stationary Cold Water High Pressure Cleaners



Wall-mounted  
Models - 599/799/899 TS



Ecowash 230 - 11L at 140 Bar  
Ecowash 400 - 12L at 160 Bar



Wall-mounted  
Models - 800/1000/1200/1500 TS

## Carwash Swivel Booms

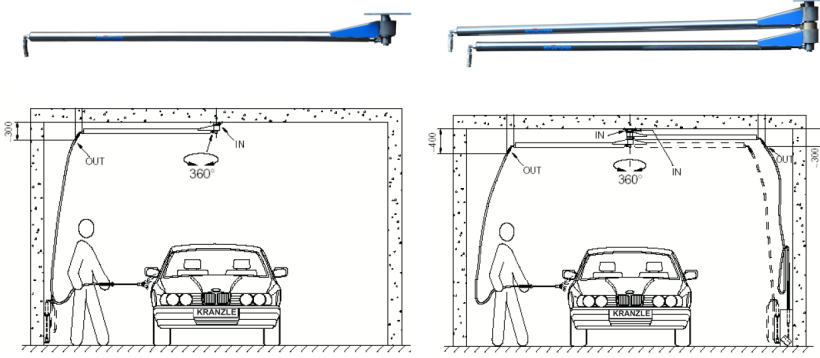

Single Swivel Boom

Double Swivel Boom



## Kranzle Foaming



Kranzle Foamer - Requires air, water and chemical supply



Kranzle Foaming Bottle  
Available 1L or 2L

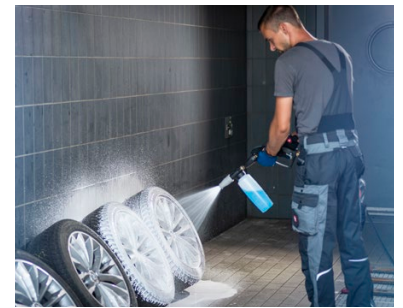

## Vacuum Cleaner Range



30L Wet and Dry  
1 x 1000W - 230V

80L Wet and Dry  
2 x 1000W - 230V

80L Wet and Dry  
3 x 1000W - 230V

Ventos 30L Wet and Dry  
1200W - 2400W

## Vacuum with Interceptor



## Carpet and Valet Products



Predator Upholstery / Carpet Extractor 40L  
2 x 3-stage motor



Sniper Upholstery / Carpet Extractor 20L  
1 x 3-stage motor



Valet Dryer for drying the interior of vehicles  
230V/400V

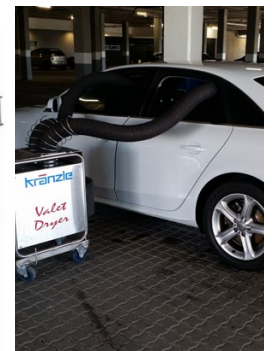



## Hot Water High Pressure Cleaners



Wall-mounted Electra

24kW - 36kW - 48kW - 72kW



Electra Mobile

Model	Electra 24	Electra 36	Electra 48	Electra 72
Working Pressure (Bar)	180 Bar	180 Bar	200 Bar	200 Bar
Max Pressure	200 Bar	200 Bar	220 Bar	220 Bar
Water Flow	10 L/M	10 L/M	13 L/M	13 L/M
Motor Rating	5.5 kW	5.5 kW	7.5 kW	7.5 kW
Motor RPM	1400 r.p.m.			
Supply Voltage	400V - 3 phase			
Heating Elements kW	24 kW	36 kW	48 kW	72 kW
Current Supply Required	40A	60A	80A	120A
Max Temp on Exit	60°	70°	80°	95°
Dimensions Cabinet	1250 mm x 600 mm x 400 mm			



Therm 890 - 1017

Various flow rates and working pressures available.

## Profi Petrol / Mobile High Pressure Cleaners



B13/150 - 13L at 150 Bar  
Petrol - Yamaha



B16/220 - 16L at 220 Bar  
Petrol - Yamaha



B13/150 - 13L at 150 Bar  
Petrol - Honda or Torx



B16/250 - 16L at 250 Bar  
Petrol - Honda



Skid-mounted version

## Tecnovap Steam Generators



Evo Blu  
6 bar - 230V



Evo 304  
8 bar - 230V



Carmen Plus Inox  
6 bar - 230V



Junior Star Max  
8 bar - 230V



Steam Box Industrial  
Various models up to 36kW

## Mosmatic Accessories for High Pressure Cleaners



Hurricane Underbody Cleaner



All Rounder



Professional



TRL Wand



Duct Cleaner



Roof Cleaner

## Iteco Single Brush Wash Systems



Easywash D500  
Diesel - 6,5 HP



Easywash 50E  
400V



## Boiler Cleaning



Quadro 800



Boiler Cleaning Kit with Foot switch



Pre-rinsing nozzle



Hydro Head Drive

## Accessories



Starlet Gun / Short Gun  
M22 or Quick-coupling



Standard Lance / Adjustable  
Vario Jet Lance



Retractable  
Hose Reel



Gun Holder  
Floor Mounted



Gun Swivel



Hose Connector



Dirtkiller and Turbokiller  
Increases cleaning  
power by 50%

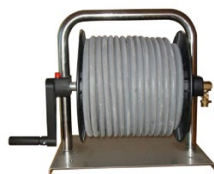

Wall-Mounted Hose Reel



Spray Guard

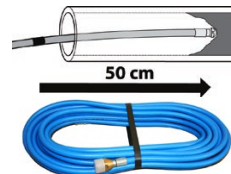

Pipe / Drain Cleaning Hose  
10, 15, 20 and 30m



Foaming Bottle



Sandblasting lance  
minimum 10L per minute



Sludge Sucker / Pumps up  
to 20 000L per hour



Underbody Lance



Round Cleaners



## Wine Barrel Cleaning



Stainless Steel Barrel Cleaner on frame



Washing in progress



On-the-Cradle Barrel Cleaner

## Cleaning on the Cradle



Loading of cradles



Barrels in position for cleaning



Control panel

## Steamer



Steamer - 9, 18, 27 or 36kW  
Higher output models on request

## Wine Tank Warmer



Wine Tank Warmer - 18kW  
Higher output models on request